

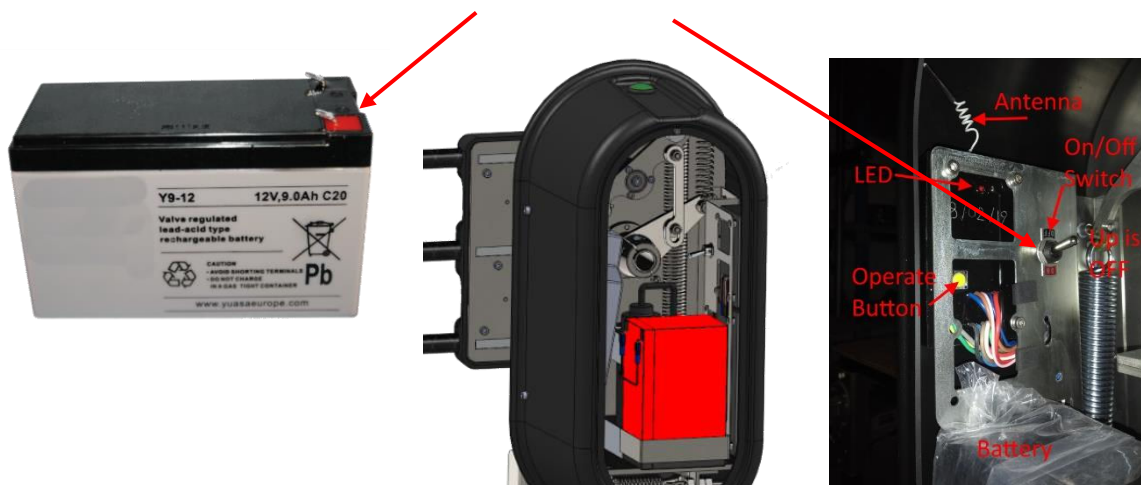

Changing battery

Key provided to open cabinet.

1. Open cabinet.
2. Pull wires off battery terminals.
3. Replace old battery with new.
4. Red wire on red marked battery terminal
5. Check internal on/off switch is **on (down)**
6. Close and lock cabinet
7. Check operation with transmitter
8. If barrier does not work check battery connections and switch
9. If barrier still does not work check signal received from transmitter – the red LED marked below should flash when transmitter button is pressed. If it does not work use spare transmitter supplied with maintenance pack and call or email Dofygate.



You should have a maintenance pack with a spare transmitter, battery, and charger – if so keep these to one side and if the barrier slows down or plays up use the spare battery and charge the one removed.

It is extremely unlikely you will need to do this until the end of Feb and only then if the next 6 weeks are unusually dull and cold.

Mark the two batteries removed as 'discharged do not use' Charging them now will mean you end up recycling damaged batteries that will not hold a full charge. Return these damaged batteries with barriers when done please.